

Because life is

PettyTM
Real

189 Gannow Lane
Burnley
BB12 6HY



For Sale
Asking Price £90,000



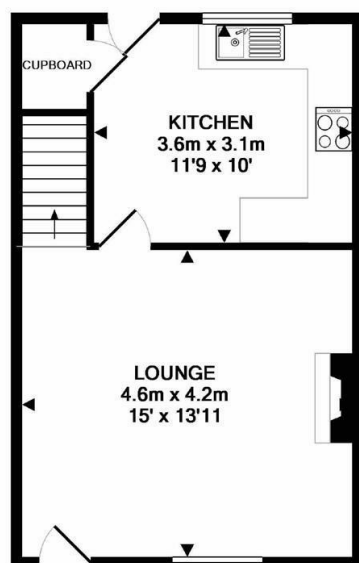

GROUND FLOOR
APPROX. FLOOR
AREA 33.3 SQ.M.
(358 SQ.FT.)

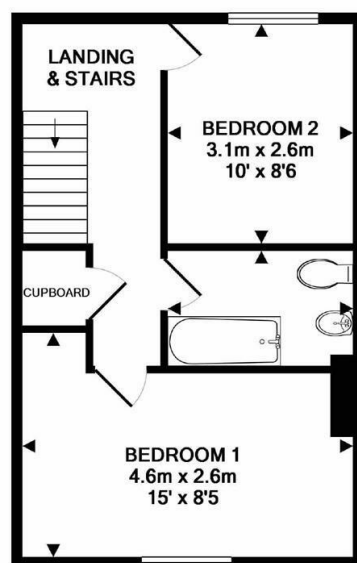

1ST FLOOR
APPROX. FLOOR
AREA 32.9 SQ.M.
(354 SQ.FT.)

TOTAL APPROX. FLOOR AREA 66.1 SQ.M. (712 SQ.FT.)

Whilst every attempt has been made to ensure the accuracy of the floor plan contained here, measurements of doors, windows, rooms and any other items are approximate and no responsibility is taken for any error, omission, or mis-statement. This plan is for illustrative purposes only and should be used as such by any prospective purchaser. The services, systems and appliances shown have not been tested and no guarantee as to their operability or efficiency can be given
Made with Metropix ©2018



These particulars, whilst believed to be accurate are set out as a general outline only for guidance and do not constitute any part of an offer or contract. Intending purchasers should not rely on them as statements of representation of fact, but must satisfy themselves by inspection or otherwise as to their accuracy. No person in this firm's employment has the authority to make or give any representation or warranty in respect of the property.

4 Manchester Road, Burnley, Lancashire, BB11 1HH
T.

burnley.sales@pettyreal.co.uk burnley.lettings@pettyreal.co.uk
property.management@pettyreal.co.uk

www.pettyreal.co.uk